

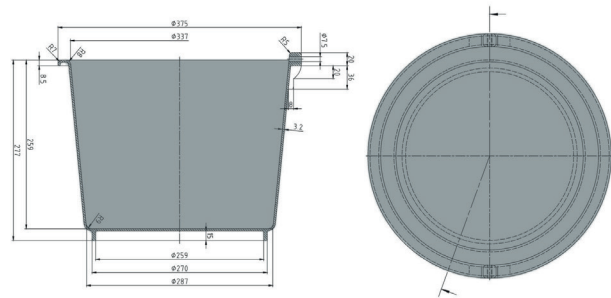

## Buckets

20 l



Art. no. 90000434

Technical data *1					
External Dimensions L x W x H (mm)	Ø 380 (top) x 280				
Internal Dimensions L x W x H (mm)	Ø 337 (top) x 255				
Weight (kg)	1.3				
Volume (l)	20				
Material	HDPE, handles zinc-coated				
Load capacity (kg)	<table border="0"> <tr> <td> <b>Holding Capacity</b></td> <td>20</td> <td> <b>Extra Load</b></td> <td>—</td> </tr> </table>	 <b>Holding Capacity</b>	20	 <b>Extra Load</b>	—
 <b>Holding Capacity</b>	20	 <b>Extra Load</b>	—		
Stacking height (mm)	<table border="0"> <tr> <td> <b>When nested</b></td> <td>45</td> <td> <b>When stacked</b></td> <td>—</td> </tr> </table>	 <b>When nested</b>	45	 <b>When stacked</b>	—
 <b>When nested</b>	45	 <b>When stacked</b>	—		
Characteristics	Options				
Colour: nature Round, with steel handles Nestable For temperatures ranging from -30 °C to +40 °C, briefly up to +90 °C Resistant to most chemicals and cleaning agents Food-safe. HACCP compliant	—				
Loading quantities (pcs/approx.)					
On request.					
Labelling options					
Customised printing and numbering available on request depending on quantity. Position upon consultation.					

\*1 All technical data include characteristic features, which have been tested under specially defined conditions. Varying data may result from different conditions of usage such as loading method, prevailing temperature and length of storage time. All data and specified information are subject to change without notice. Our service team is pleased to be at your disposal to check the special requirements of your individual application.