

CR4-5

48" x 40"

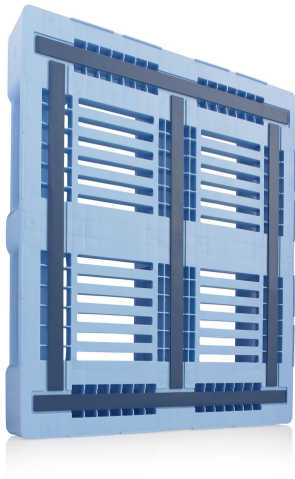

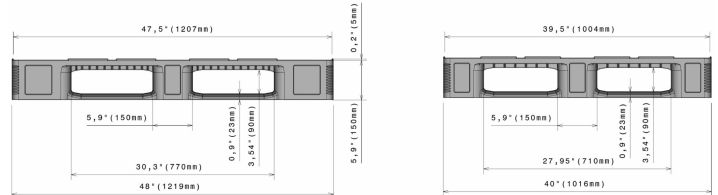

Art.-Nr.: 83350301

Palgrip



Technical Data*1

Dimensions L x W x H	48 x 40 x 5.9" (1219 x 1016 x 150 mm)		
Weight (lbs)	51.8 lbs		
Material*2	PE		
Load capacity (lbs)	 Static 16550 lbs	 Dynamic 2800 lbs	 In Racking System 2200 lbs

Characteristics

Color: light blue / blue
 Runners: 5, unwelded
 Lips: 0.2"
 Antislip: Palgrip® anti-slip strips on the top deck
 Temperature stability: -22°F to +104°F, briefly up to +194°F

Options

Lip options
 Transponder (RFID)
 Reinforcement profiles

Loading quantities (Pcs / Approximate amount)

 Container	Container 20': 154	Container 40' High Cube: 358
	Container 40': -	Conventional trailer 45' high cube container: -
 Truck	MEGA-Trailer: 494	Jumbo: 532-570

Labelling

Customised printing and numbering available on request depending on quantity. Position upon consultation.

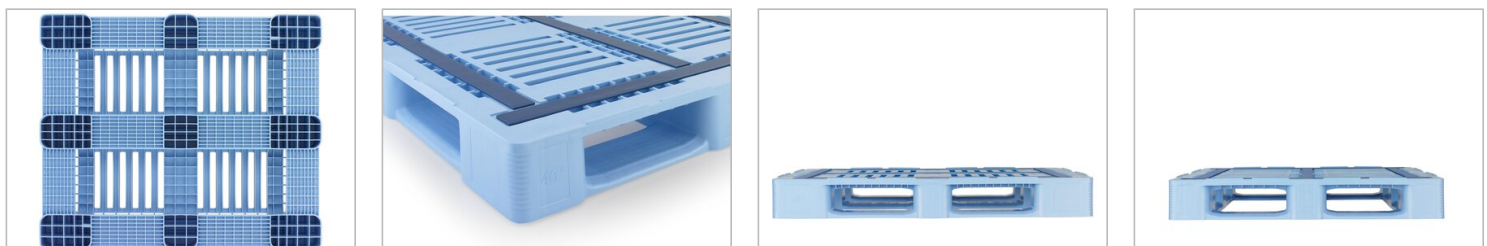

*1 All technical data reflect characteristic features tested under specially defined conditions. Variations may occur due to different usage conditions, such as loading method, ambient temperature, and storage duration. All data and specifications are subject to change without notice. Our service team is happy to assist in reviewing the specific requirements of your individual application.

*2 Our service team is available to provide precise information about material compositions.

*3 **Static load:** Resistance to pressure on a flat surface with an evenly distributed load at a room temperature of approx. 68°F.
Dynamic load: On a forklift with an evenly distributed load at a room temperature of approx. 68°F.
In racking system: Evenly distributed load (sacks) along the longitudinal sides, resting on two supports for over 100 h at a room temperature of approx. 68°F.