

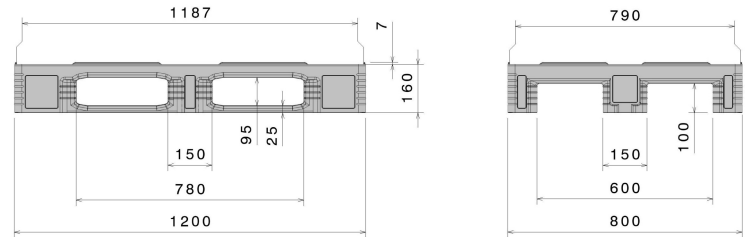





# TC1

47.2" x 31.5"



Art.-Nr.: 87065301

Technical Data*1			
Dimensions L x W x H	47.2 x 31.5 x 6.3 " (1200 x 800 x 160 mm)		
Weight (lbs)	39.7 lbs		
Material*2	PE		
Load capacity (lbs)	 <b>Static</b> 16550 lbs	 <b>Dynamic</b> 2800 lbs	 <b>In Racking System</b> 2200 lbs
Characteristics		Options	
Color: light blue Runners: 3, unwelded Lips: 0.3 " Temperature stability: -22°F to +104°F, briefly up to +194°F		Transponder (RFID) Reinforcement profiles Lip options Lid	
Loading quantities (Pcs / Approximate amount)			
 <b>Container</b>	Container 20': <b>192</b> Container 40': <b>390</b>	Container 40' High Cube: <b>440</b> Conventional trailer 45' high cube container: -	
 <b>Truck</b>	MEGA-Trailer: <b>612</b>	Jumbo: <b>684</b>	
Labelling			
Customized printing and numbering available on request depending on quantity. Position upon consultation.			

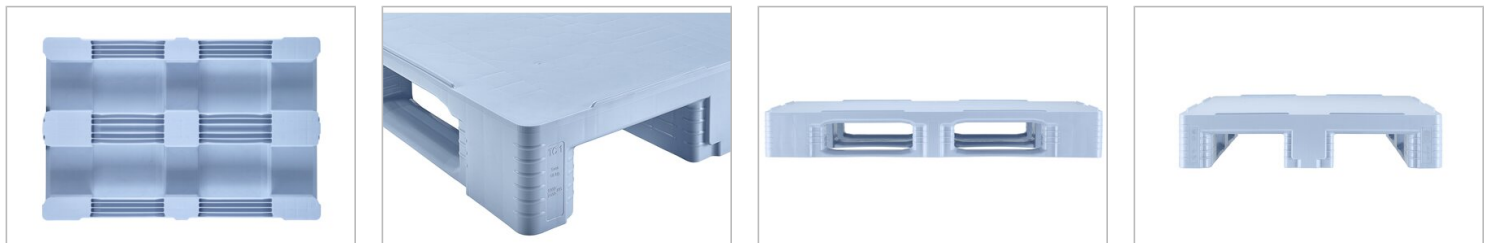

- \*1 All technical data reflect characteristic features tested under specially defined conditions. Variations may occur due to different usage conditions, such as loading method, ambient temperature, and storage duration. All data and specifications are subject to change without notice. Our service team is happy to assist in reviewing the specific requirements of your individual application.
- \*2 Our service team is available to provide precise information about material compositions.
- \*3 **Static load:** Resistance to pressure on a flat surface with an evenly distributed load at a room temperature of approx. 68°F.  
**Dynamic load:** On a forklift with an evenly distributed load at a room temperature of approx. 68°F.  
**In racking system:** Evenly distributed load (sacks) along the longitudinal sides, resting on two supports for over 100 h at a room temperature of approx. 68°F.