

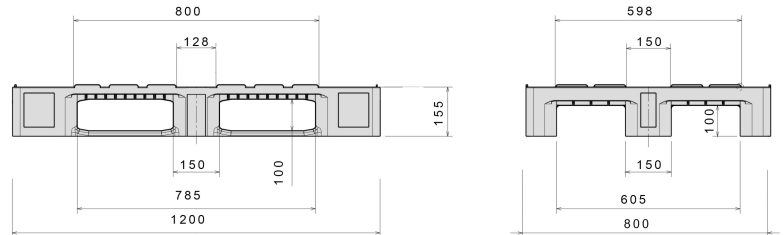

H1 ESD

47.2" x 31.5"



Art.-Nr.: 83102222

Technical Data*1				
Dimensions L x W x H		47.2 x 31.5 x 6.3 " (1200 x 800 x 160 mm)		
Weight (lbs)		38.6 lbs		
Material*2		PE, ESD		
Load capacity (lbs)		<div> Static 11000 lbs</div>	<div> Dynamic 2200 lbs</div>	<div> In Racking System 1850 lbs</div>
Characteristics		Options		
Color: black		Lip options		
Runners: 3, unwelded		Lid		
Lips: 0.3 "		Transponder (RFID)		
Temperature stability: -22°F to +104°F, briefly up to +194°F				
ESD pallet				
Surface resistance of ≥ 1 x 10 E4 Ohm to < 1 x 10 E11 Ohm				
Loading quantities (Pcs / Approximate amount)				
<div> Container</div>	Container 20': 192 Container 40': 390	Container 40' High Cube: 440 Conventional trailer 45' high cube container: -		
<div> Truck</div>	MEGA-Trailer: 594	Jumbo: 684		
Labelling				
Customized printing and numbering available on request depending on quantity. Position upon consultation.				



*1 All technical data reflect characteristic features tested under specially defined conditions. Variations may occur due to different usage conditions, such as loading method, ambient temperature, and storage duration. All data and specifications are subject to change without notice. Our service team is happy to assist in reviewing the specific requirements of your individual application.

*2 Our service team is available to provide precise information about material compositions.

*3 **Static load:** Resistance to pressure on a flat surface with an evenly distributed load at a room temperature of approx. 68 °F.
Dynamic load: On a forklift with an evenly distributed load at a room temperature of approx. 68 °F.
In racking system: Evenly distributed load (E2 boxes or Euro fish boxes) along the longitudinal sides, resting on two supports for over 100 h at a room temperature of approx. 68 °F.