

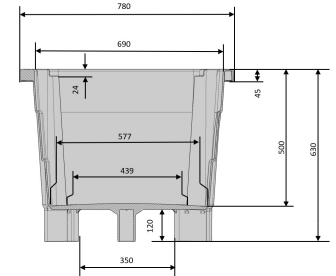

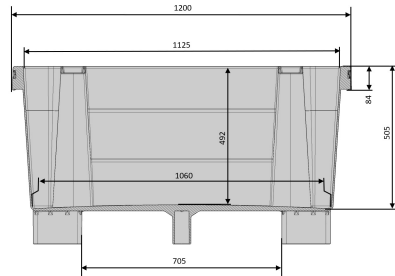

Economic Transport box

300 l



Art.-Nr.: 81301810

Technical data	
External Dimensions L x W x H (mm)	1200 x 780 x 630
Weight (kg)	17.7 kg
Volume (l)	300 l
Material* ²	PE
Load capacity (kg)* ³	<div style="display: flex; justify-content: space-around;"> <div style="text-align: center;">  <p>Holding Capacity 250 kg</p> </div> <div style="text-align: center;">  <p>Extra Load 785 kg</p> </div> </div>
Stacking height (mm)	<div style="display: flex; justify-content: space-around;"> <div style="text-align: center;">  <p>When nested 140 mm</p> </div> <div style="text-align: center;">  <p>When stacked 605 mm</p> </div> </div>

Characteristics	Options
Colour: light grey 5 feet Nestable, stackable For temperatures ranging from -30 °C to +40 °C, briefly up to +90 °C Resistant to most chemicals and cleaning agents Accessible with forklift and lift truck Food-safe. HACCP compliant	Transponder (RFID)

Loading quantities (Pcs / Approximate amount)
On request

Labelling
Customised printing and numbering available on request depending on quantity (except trolleys). Position upon consultation.



*1 All technical data include characteristic features, which have been tested under specially defined conditions. Varying data may result from different conditions of usage such as loading method, prevailing temperature and length of storage time. All data and specified information are subject to change without notice. Our service team is pleased to be at your disposal to check the special requirements of your individual application.

*2 Our service team is pleased to be at your disposal if you require exact information about material compositions.

*3 Load capacity: with a payload of 250 kg at a room temperature of approx. 20 °C.