

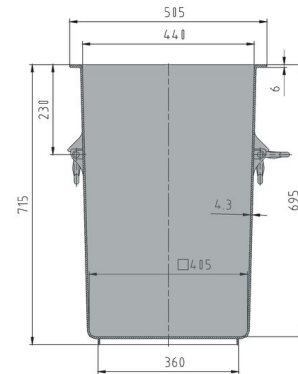

Large container

125 l



Art.-Nr.: 81031010

Technical data

External Dimensions L x W x H (mm)	505 x 505 x 715
Internal Dimensions L x W x H (mm)	440 x 440 x 695
Weight (kg)	5.8 kg
Volume (l)	125 l
Material	PE

Load capacity (kg)  **Holding Capacity** 125 kg

 **Extra Load** 265 kg

Stacking height (mm)  **When nested** 250 mm

 **When stacked** 695 mm

Characteristics

Colour: white
 Nestable, stackable with lid
 For temperatures ranging from -30 °C to +40 °C, briefly up to +90 °C
 Resistant to most chemicals and cleaning agents
 Food-safe. HACCP compliant

Options

Lid

Loading quantities (Pcs / Approximate amount)

On request

Labelling

Customised printing and numbering available on request depending on quantity. Position upon consultation.



*1 All technical data include characteristic features, which have been tested under specially defined conditions. Varying data may result from different conditions of usage such as loading method, prevailing temperature and length of storage time. All data and specified information are subject to change without notice. Our service team is pleased to be at your disposal to check the special requirements of your individual application.